

REV.	DESCRIPTION	DATE	DESIGNER	APPROVED
A/0	The last word	06/04/11	W.X.Y	

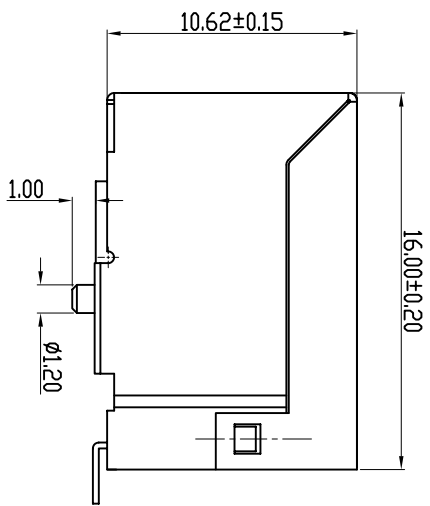
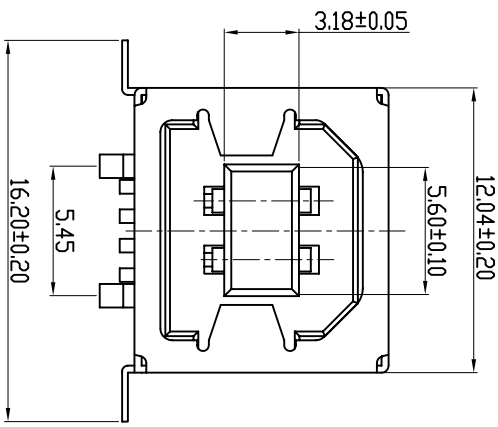

PART NO EXPLAIN:
USB-B1M06F-□□4□

Shell Plate spec: T=Plateg tin, N=Plateg nickel
Housing Color: B=Black, N=Nature, W=White
Contact Plate spec: (0=FU', 1=3U', 2=6U', 3=15U', 4=30U')

Specification

- 1.Voltage Current Rating:1AMP.30V AC
- 2.Insulation Resistance:1000MΩ Min
- 3.Contact Resistance:30mΩ Max
- 4.Dielectric Withstanding Voltage:500V AC
- 5.Temperature Range:-20°C to +60°C

NOTE:

Tolerances unless otherwise specified:
0-10:±0.15; 10-20:±0.20; 20-30:±0.25

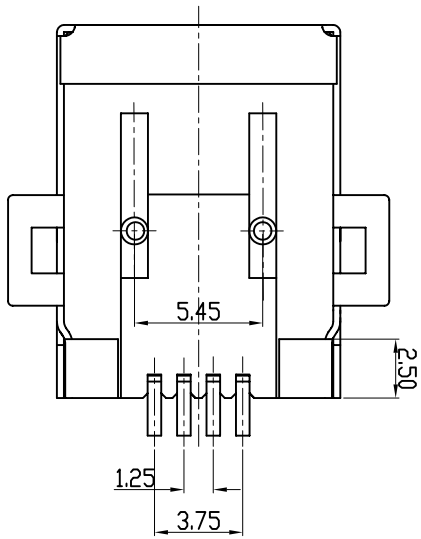
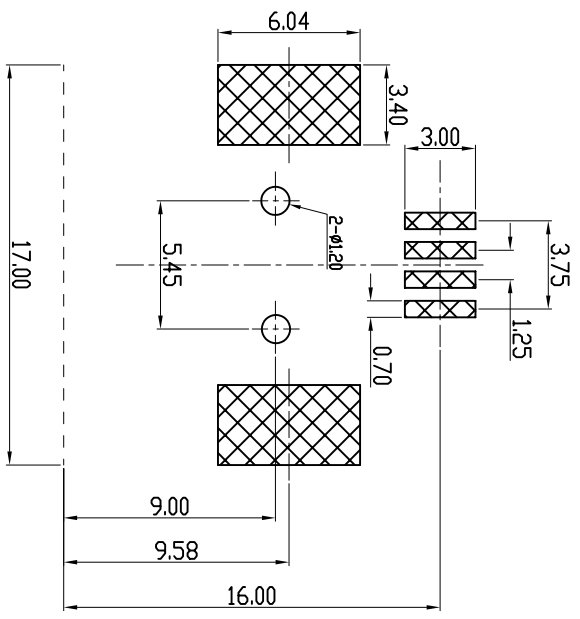

NO.	VARIETY	MATERIAL	QTY	REMARK
3	Shell	C2680	1	T=0.25 Plateg nickel
2	Housing	PA6T	1	U194V-0 Nature/Black/White
1	Contact	C2680	4	T=0.30 Plateg Gold

CZT® DONGGUAN YIHUA ELECTRONIC CO., LTD

UNIT:	mm	DESIGNER:	W.X.Y	TITLE:	USB B TYPE(FEMALE) SMT		
3RD:		APPRD:		SHEET:	1	PART NO.:	USB-B1M06F-□□4□
SCALE:	1:1	EXAMINE:		CHART NO.:	1114-0006	MATE NO.:	
REV:	A/0						

PCB EDGE